

TOPSILENTGips

THERMAL-ACOUSTIC INSULATION IN PLASTERBOARD COUPLED TO A HIGH DENSITY SOUNDPROOFING FOIL WITH A VERY HIGH CRITICAL FREQUENCY FOR WALLS, FALSE WALLS AND INSULATING FALSE WALLS ON A METAL FRAME

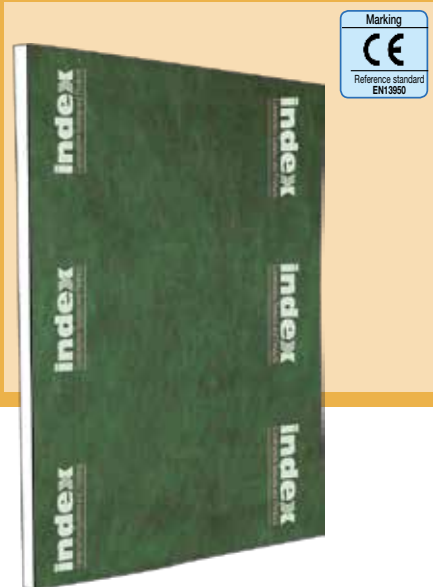

GRANTS LEED CREDITS

CHARACTERISTICS		ENVIRONMENTAL		
ACOUSTIC INSULATION	THERMAL INSULATION	ECO GREEN	RECYCLABLE	SAFE WASTE

1 PROBLEM

To increase the acoustic insulation of walls, false-walls and false-ceilings in plasterboard on metal framework, some systems are created that are made up of a number of panels overlapped, which take much longer to assemble.

2 SOLUTION

The increased weight of the wall in plasterboard increases acoustic insulation and this is why a number of panels are laid over each other or coupled on-site with heavy materials such as those of the TOPSILENT range, with high critical frequency that damp the vibrations on the panel.

TOPSILENTGips is obtained in our factory by coupling a plasterboard panel with the TOPSILENTBitex foil. Consequently, the laying jobs previously carried out on-site are eliminated.

TOPSILENTGips is a prefabricated panel that provides higher acoustic insulation performance compared to that of the single plasterboard panel, thanks to the

TOPSILENTBitex coupling, which is a high density elastomer foil with soundproofing power equal to a lead foil of the same weight but without the latter's toxic properties. **TOPSILENTGips** is indeed lead-free. The acoustic insulation performance of **TOPSILENTGips** - whether fitted in false-walls on a metal framework next to a brick wall, or in walls made entirely of lined plasterboard on a metal frame - has been certified by ITC-CNR in Milan, using 13 mm plasterboard panels and TOPSILENTBitex weighing 5 Kg/m² pre-coupled on-site with FONOCOLL glue.

METHOD OF USE

TOPSILENTGips panels are to be screwed to a metal frame and covered with another plasterboard panel, better still if with offset joints. For double panel walls, **TOPSILENTGips** can be installed in two ways: with the lined face against the frame; with TOPSILENTBitex in-between the two panels.

The joining lines between the panels are then sealed with the joint concealing tape NASTROGIPS and grouted with the special finishing STUCCOJOINT filler.

Store the panels indoors.

If you wish to line walls in brick or concrete, stick the panels with GIPSCOLL glue.

APPLICATION FIELDS

The **TOPSILENTGips** panel is used in the building industry to build walls with high acoustic insulation properties. In view of TOPSILENTBitex's high resistance to vapour migration, it also acts as a barrier against the vapour of the thermal-acoustic insulation material in the perimeter walls bordering the outside.

TOPSILENTGips can be used both for building insulating false-walls of existing walls and for building new walls made totally of plasterboard panels.

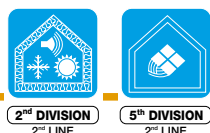
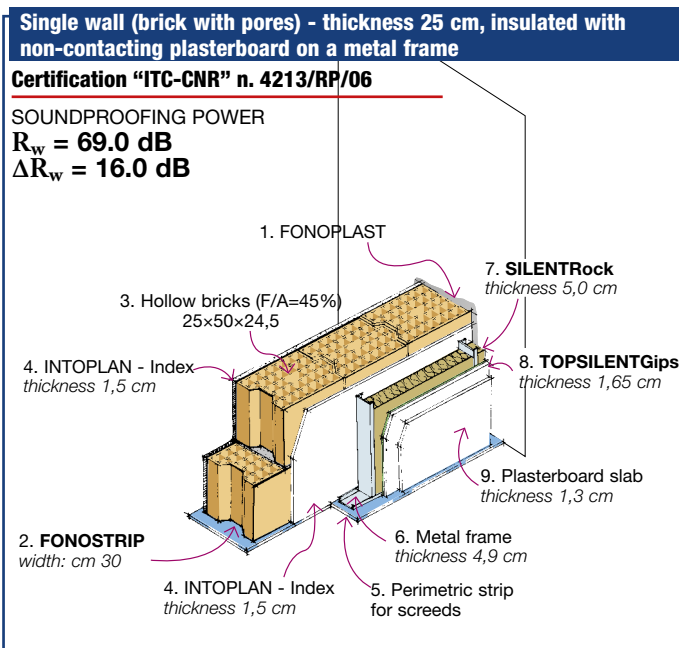
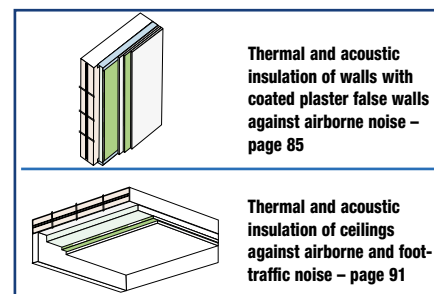

TOPSILENTGips

Thickness		16.5 mm
Dimension		1.2x2.0 m
Mass per unit area		15 kg/m ²
Thermal resistance R	EN 12667	0.05 m ² K/W
Aqueous vapour diffusion coefficient		μ 100 000
Bending strength	EN 520	Conforming
Specific heat.		1.03 KJ/kgK
Fire reaction classification	EN 13501-1	Class F
Certification		

the numerous possible uses and the possible interference of conditions or elements beyond our control, we assume no responsibility regarding the results which are obtained. The purchasers, of their own accord and under their own responsibility, must establish the suitability of the product for the envisaged use.

The figures shown are average indicative figures relevant to current production and may be changed or updated by INDEX at any time without previous warning. The advice and technical information provided, is what results from our best knowledge regarding the properties and the use of the product. Considering

• THE TECHNICAL SPECIFICATIONS MAY BE VIEWED AND DOWNLOADED ON THE RELEVANT PRODUCT DATA SHEET AT www.indexspa.it •

• FOR THE CORRECT USE OF OUR PRODUCTS, CONSULT INDEX TECHNICAL SPECIFICATIONS • FOR FURTHER INFORMATION OR SPECIAL USES, CONSULT OUR TECHNICAL OFFICE •

index
Construction Systems and Products

Via G. Rossini, 22 - 37060 Castel D'Azzano (VR) - Italy - C.P.67
T. +39 045 8546201 - F. +39 045 518390

Internet: www.index-spa.com
Informazioni Tecniche Commerciali
tecom@indexspa.it
Amministrazione e Segreteria
index@indexspa.it
Index Export Dept.
index.export@indexspa.it

