

RASOPLAN

MEDIUM GRAIN SMOOTHING PRODUCT
FOR INTERIOR AND EXTERIOR PLASTER AND WALL FINISHES



GRANTS *LEED* CREDITS

CHARACTERISTICS	ENVIRONMENTAL	METHOD OF USE		PRECAUTIONS
ALLOWS TO BREATHE	ECO GREEN	RECYCLABLE	MIX MECHANICALLY	STORAGE: IN A DRY PLACE
			APPLY BY INOX SPATULA	

PROBLEM

SMOOTH WALLS WITH OR WITHOUT PLASTER



SOLUTION

RASOPLAN is premixed cement-based powders with selected mineral aggregates and additives that improve workability and adhesion. Once set they appear as compact and resistant plaster with excellent anti-cracking capacity.

APPLICATION FIELDS

RASOPLAN is used to smooth all normal indoor and outdoor surfaces (concrete, cement+lime mortar or cement mortar, cement foam etc.). It is used to smooth off loose or ruined plaster and to level off walls that are not perfectly flat, even those made of brick.

RASOPLAN, with added COLLASEAL, can be used to smooth plastic-type finishes or mineral civil plaster, applied with both trowel and blade.

ADVANTAGES

- Excellent workability to resolve filling and smoothing problems with just one product.
- Excellent level of finish.
- High adhesion to normal surfaces.
- Excellent resistance to cracking.



METHOD OF USE

The underlying surface must be compact and perfectly clean, without dust, loose parts, old paint etc.

When applying over highly absorbent surfaces it is advisable to wet beforehand.

Gypsum underlying surfaces must first be treated with ISOLFIX G primer.

• MIX PREPARATION

RASOPLAN is prepared by mixing the product with right quantity clean water (see table) (1). Use a low speed mixing drill without over-mixing.

• APPLICATION

Apply the product using an inox spatula, smoothing out in an even thickness (2). One or more coats can be applied depending on the required finish.

• CONSUMPTION

About 14 kg/m²×cm.

• PRECAUTIONS

- Use cold water in the summer and water at 20°C in the winter.
- Application temperature from +5°C to +35°C.
- Do not add other materials such as bonding agents, aggregates or additives.
- In hot weather, keep the surface of the laid mortar wet, preventing the product from drying out quickly, for at least 8 hours.
- Wet the surfaces in high temperatures.
- Do not add water when the mix starts to set.
- Avoid sudden temperature changes while the plaster is setting.
- Store in original closed packaging in a dry place. Protect against frost and high temperatures.

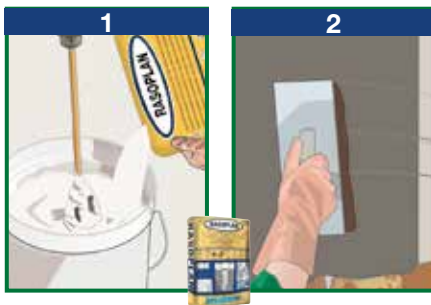

TECHNICAL CHARACTERISTICS

		RASOPLAN
Appearance		Powder
Colour		Grey White
Particle size		0÷0.6 mm
Apparent density	EN 1015-6	1.40 ± 0.05 kg/L
Mixing water		18% ± 1%
Storage in original packaging in a dry place		12 months
Mix properties and workability		
Density of the mix		1.80 ± 0.05 kg/L
Application temperature		+5°C ÷ +35°C
Minimum application thickness		1.0 mm
Maximum application thickness per layer		10.0 mm
Application		Manual or mechanical
Performance characteristics	Standards	Product performance
Class and type	EN 998-1	GP
Resistance to compression - after 28 days	EN 1015-11	>10.0 N/mm ² - CS IV
Resistance to bending - after 28 days	EN 1015-11	3.0 N/mm ²
Adhesion to substrate	EN 1015-12	≥0.5 N/mm ² - FP: A
Water absorption through capillarity	EN 1015-18	W0
Water vapour permeability coefficient	EN 1015-19	μ = 15
Thermal conductivity $\lambda_{10,dry}$	EN 1745 A.12	0.76 W/mK
Durability	EN 998-1	5.2.3.2 compliant
Thermal resistance - Working temperature		-30°C ÷ +90°C
Reaction to fire	EN 13501-1	A1
Hazardous substances	EN 998-1	According note in ZA.1

Test conditions: temperature 23±2°C, 50±5% R.H. and air velocity in test area <0.2 m/s. **These parameters may vary based on the specific conditions of the worksite: temperature, humidity, ventilation, porosity of the substrate.**

(*) The stated times may be longer or shorter as the temperature decreases or increases.

Compliant with the general principles defined in **EN 998-1** - Principles for evaluation of the use of products and systems.

the numerous possible uses and the possible interference of conditions or elements beyond our control, we assume no responsibility regarding the results which are obtained. The purchasers, of their own accord and under their own responsibility, must establish the suitability of the product for the envisaged use.

The figures shown are average indicative figures relevant to current production and may be changed or updated by INDEX at any time without previous warning. The advice and technical information provided, is what results from our best knowledge regarding the properties and the use of the product. Considering

PACKAGING

25-kg Sack.

• FOR ANY FURTHER INFORMATION OR ADVICE ON PARTICULAR APPLICATIONS, CONTACT OUR TECHNICAL OFFICE • IN ORDER TO CORRECTLY USE OUR PRODUCTS, REFER TO INDEX TECHNICAL SPECIFICATIONS •

<p>index Construction Systems and Products</p> <p>Via G. Rossini, 22 - 37060 Castel D'Azzano (VR) - Italy - C.P.67 T. +39 045 8546201 - F. +39 045 518390</p>	<p>Internet: www.index-spa.com Informazioni Tecniche Commerciali tecom@indexspa.it Amministrazione e Segreteria index@indexspa.it Index Export Dept. index.export@indexspa.it</p>		<p>TOTAL QUALITY index UNI EN ISO 9001</p>	<p>Environmental Management Systems index UNI EN ISO 14001</p>	<p>index "GBC Italia" Associated</p>	<p>lavorosicuro</p>
--	--	--	--	--	---	----------------------------