

RAPIDBOND

QUICK-SETTING, HIGH-ADHESION, CEMENT-BASED, SUPER ADHESIVE
 VERY SUBJECT TO CHANGEABILITY
 FOR APPLICATION OF LARGE CERAMIC TILES AND NATURAL STONE,
 ON INTERNAL AND EXTERNAL FLOORS AND LINING
 ALSO WHEN OVERLAYING EXISTING TILES

GRANTS *LEED* CREDITS

CHARACTERISTICS	ENVIRONMENTAL	METHOD OF USE		PRECAUTIONS
 ONE-COMPONENT	 ECO GREEN	 RECYCLABLE	 MIX MECHANICALLY	 APPLY BY TOOTHED SPATULA
			 STORAGE: IN A DRY PLACE	

PROBLEM

**QUICK APPLICATION
 (EVEN IN OVERLAY)
 TO ALLOW
 IMMEDIATE
 FOOT TRAFFIC**

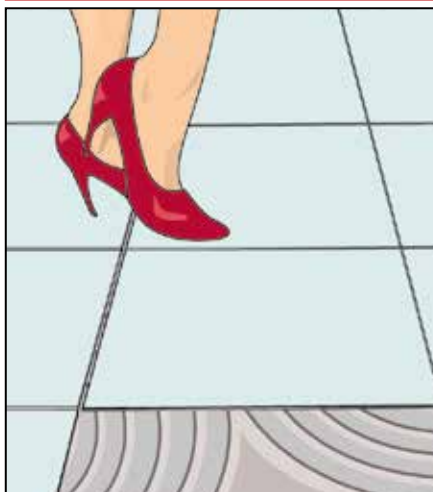

In restructuring and rebuilding work, where immediate access is necessary, a rapid setting adhesive is required which offers improved adhesion, even in overlay situations when used on generally non-absorbent surfaces and flooring.

SOLUTION

RAPIDBOND is a prepared special adhesive in powder form, manufactured from a blend of special cements, selected inert material, synthetic resins in powder form and additives which improve handling and adhesion. Rapid setting develops a tough, resistant bond after only 4 hours.

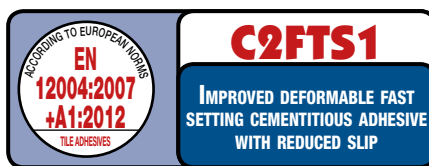

ADVANTAGES

- RAPIDBOND is fast to apply and fit for use immediately.
- RAPIDBOND offers improved and secure adhesion, even on non-absorbent surfaces.
- Dries rapidly, a characteristic which makes it ideal for use in winter.

APPLICATION FIELDS

RAPIDBOND is used to fix ceramic tiles both indoors and outdoors new floors or walls or superimposing on existing ones.

It is particularly used for:

- rebuilding bathrooms, kitchens, terraces;
- in overlay situations on existing non-absorbent flooring where ordinary adhesives would be too slow setting;
- rapid bonding of tiles and mosaic in surroundings exposed to damp and frost;
- spot bonding for insulating panels such as polystyrene, polyurethane, plasterboard, wood-cement, etc;
- areas where immediate foot traffic is required, such as industrial establishments, public places, cold rooms, swimming pools, etc.

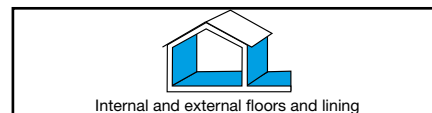

METHOD OF USE

• SURFACE PREPARATION

The foundation onto which the adhesive is applied, must be clean and free from dust, oil and form-releasing greases. Before laying on gypsum, anhydrite and quick-drying screeds, insulating treatment with ISOLFIX G is required. **On difficult surfaces which are subjected to movement and vibrations, on heated flooring and when applying large tiles, use RAPIDBOND with ELASTOBOND.** When laying on top of glazed or very smooth ceramic tiles, the latter must be bush hammered in advance to improve adhesion.

• MIX PREPARATION

RAPIDBOND is prepared by mixing the product with right quantity clean water (see

table). Pour the powder product into the water and mix with a drill on low speed until a uniform paste is obtained with no lumps (1). Leave the paste to rest for 3 minutes and mix again. The mix stays in workable condition for about 1 hour depending on weather conditions.

• APPLICATION

Spread RAPIDBOND with a toothed trowel (2). For exterior applications, it is advisable to apply over the back of the tiles; this will avoid water getting into feasible cavities and freezing, which could cause tile detachment. Press the tile down well to ensure a good adhesive bond. This product is very quick-drying (15 minutes) and

consequently tiles must also be set quite quickly. Dampen the support surface if necessary during very hot periods.

(See following)

CERTIFICATION



TVFA
 tu Wien



TECHNICAL CHARACTERISTICS

		RAPIDBOND	
		Powder	
		White	Grey
Appearance			
Colour			
Apparent density	EN 1015-6	1.30 ± 0.05 kg/L	1.30 ± 0.05 kg/L
Water ratio		24% ± 1%	24% ± 1%
Shelf life in original packaging (dry stored)		12 months	
Mix characteristics and workability			
Density of mix		1.60 ± 0.05 kg/L	
Mix pH		12-14	
Pot life (*)		approx 1 hour	
Application temperature		+5°C ÷ +35°C	
Open time (*)		15 minutes	
Adjustability time (*)		15 minutes	
Waiting time - before foot traffic use (*)		4 hours	
Waiting time - before grouting (*)		4 hours	
Performance characteristics	Standard	Minimum requirement	Product performance
Class and type	EN 12004		C2FTS1
Transversal deformation class of adhesive	EN 12002	>2.5	2.6 mm - class S1
Adhesion strength	EN 1348 P8.2	≥1.0 N/mm ²	1.50 N/mm ²
Early tensile adhesion strength	EN 1348 P8.2	≥0.5 N/mm ²	0.50 N/mm ²
Adhesion strength - after immersion in water	EN 1348 P8.3	≥1.0 N/mm ²	1.20 N/mm ²
Adhesion strength - after heat	EN 1348 P8.4	≥1.0 N/mm ²	1.40 N/mm ²
Adhesion strength - after thaw-frost cycles	EN 1348 P8.5	≥1.0 N/mm ²	1.10 N/mm ²
Open time: adhesion strength - after 10'	EN 1346	≥0.5 N/mm ²	0.80 N/mm ²
Sliding	EN 1348	<0.5 mm	<0.5 mm
Thermal resistance - Operating temperature			-30°C ÷ +90°C
Fire reaction	EN 13501-1		E CWFT P4.4.3
Hazardous substances	EN 12004		in accordance to ZA.1 note

Test conditions: temperature 23±2°C, 50±5% R.H. and air velocity in test area <0.2 m/s. These data may change depending on specific site conditions: temperature, ventilation, moisture and substrate absorbency. (*) The times indicated will be longer or shorter as the temperature drops or rises.

(*) The times indicated will be longer or shorter as the temperature drops or rises.

Pursuant to European standard EN 12004:2007+A1:2012 - General principles for the use of products and systems.

(See previous)

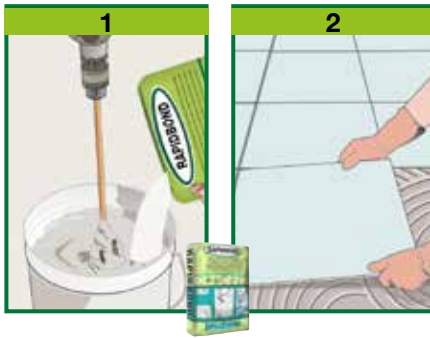

• CONSUMPTION

Between 3-5 kg/m² depending on the surface and type of tile.

• PRECAUTIONS

• Don't use on surfaces made of metal, rubber, vinyl floors, wood, linoleum or PVC.

- In case of marble or composite stones particularly sensitive to water, we suggest you to consult our technical office.
- If the back of the tiles are very dusty, it is recommended to clean them by dipping them quickly in water.
- In adverse weather conditions (high temperatures, wind) the normal open time may be shorter. Therefore you must make sure the adhesive has not formed a "skin" before laying the tile, which would compromise adhesion. If a "skin" has formed on the surface, simply refresh the adhesive by crossing again with the toothed trowel without wetting.
- In high temperatures wetting the foundation helps to increase the open time.
- Never use with temperatures below +5°C and high than +35°C. Protect tiles from rain, frost and high temperature for 24 hours at least.

- In hot weather avoid laying the adhesive on large surface areas.
- Damp surfaces can slow the setting of the product.
- When overlying, the surfaces must be washed well with water and caustic soda (9:1).
- Clean the tools with water and the covered surfaces with a damp cloth immediately after use.
- Do not expose the material to direct sunlight in hot weather.
- Store the original closed packaging in a dry place.

PACKAGING

25-kg Sacks

• FOR ANY FURTHER INFORMATION OR ADVICE ON PARTICULAR APPLICATIONS, CONTACT OUR TECHNICAL OFFICE • IN ORDER TO CORRECTLY USE OUR PRODUCTS, REFER TO INDEX TECHNICAL SPECIFICATIONS •

<p>Construction Systems and Products</p> <p>Via G. Rossini, 22 - 37060 Castel D'Azzano (VR) - Italy - C.P.67 T. +39 045 8546201 - F. +39 045 518390</p>	<p>Internet: www.index-spa.com Informazioni Tecniche Commerciali tecom@indexspa.it Amministrazione e Segreteria index@indexspa.it Index Export Dept. index.export@indexspa.it</p>		<p>TOTAL QUALITY index</p>	<p>Environmental Management Systems index</p>		
			<p>socio del GBC Italia</p>			

the numerous possible uses and the possible interference of conditions or elements beyond our control, we assume no responsibility regarding the results which are obtained. The purchasers, of their own accord and under their own responsibility, must establish the suitability of the product for the envisaged use.

The figures shown are average indicative figures relevant to current production and may be changed or updated by INDEX at any time without previous warning. The advice and technical information provided, is what results from our best knowledge regarding the properties and the use of the product. Considering