



GRANICOL AB RAPID

QUICK-SETTING AND DRYING, EXTRA STRONG POLYMER-MODIFIED CEMENT ADHESIVE TWO-COMPONENT, HIGHLY DEFORMABLE, WITH IMPROVED ADHESION FOR LAYING CERAMIC TILES, MOSAIC, MARBLE AND COMPOSITE STONES, ON INTERIOR AND EXTERIOR FLOORS AND WALLS, ALSO WHEN OVERLAYING EXISTING TILES

GRANTS *LEED* CREDITS

CHARACTERISTICS		ENVIRONMENTAL		METHOD OF USE		PRECAUTIONS	
AB	H ₂ O	ECO GREEN	RECYCLABLE	MIX MECHANICALLY	APPLY BY TOOTHED SPATULA	STORAGE: IN A DRY PLACE	STORAGE: KEEP AWAY FROM FROST
TWO-COMPONENT	WATER BASED						

PROBLEM

QUICK APPLICATION OF NATURAL AND COMPOSITE STONE

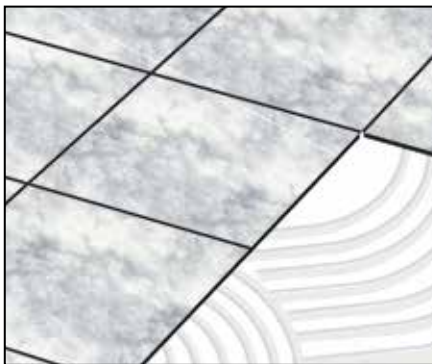

The application of natural or composite stone, glass mosaic and gres porcelain tiles always require a bonding material with excellent adhesion and flexibility. In refurbishing jobs where an immediate use of the premises is required, and a quick setting adhesive that can offer a guarantee of a very high adhesion overlaying existing floor or setting non absorbing materials.

SOLUTION

GRANICOL AB RAPID is a two part adhesive consisting of one part cement (component **A** 25 kg), made using special water-based binders, selected quartz-based sand and additives, and a water based solution (component **B** 6 kg) of special acrylic resin that improves adhesion, elasticity and waterproofing qualities. **GRANICOL AB RAPID's** special formula guarantees quick setting which allows floors to be walked on only 3 hours after laying.



APPLICATION FIELDS

GRANICOL AB RAPID is used for laying on floors and walls in both interior and exterior applications; it is particularly suitable for quick refurbishment work where immediate use of the premises is required; ideal for laying large tile sizes, on new floors and walls or on top of existent ones and for laying non-absorbent products such as vitreous mosaic and porcelain stoneware tiles. Thanks to its drying and setting speed, **GRANICOL AB RAPID** is recommended for laying marble, granite and engineered stone tiles because it limits problems related to stones that absorb water.



Internal and external floors and lining

ADVANTAGES

- **GRANICOL AB RAPID** is fast to apply and fit for immediate use.
- Provides secure adhesion even on difficult surfaces and non-absorbent tiles.
- Ideal for use with marble and granite, it does not stain and is resistant to thermal shock and mechanical stress.

METHOD OF USE

• SURFACE PREPARATION

The bottom of the tiles must be free from all dust, oil, grease, etc. The surface to which they are to be applied must be dry and even. If it is chalky, it should first be treated with ISOLFIX G.

• MIX PREPARATION

The product is prepared by mixing component **A** (the 25 kg sack) with component **B** (the 6 kg can). Use a mechanical mixer (1) and slowly pour the powder into the liquid until a uniformly smooth paste is formed. Leave the paste to rest for 3 minutes and mix again. The mix stays in workable condition for about 1 hour depending on weather conditions.

• APPLICATION

Apply the mixture with a toothed trowel according to the type of tiles to be laid (2).

When laying large non-absorbent tiles or laying objects outside, also apply a thin layer of the mixture to the bottom of the tiles.

• CONSUMPTION

Between 3-6 kg/m² according to the size of the tile and type of trowel.

• PRECAUTIONS

- Don't use on surfaces made of metal, rubber, vinyl floors, wood, linoleum or PVC.
- In case of marble or composite stones particularly sensitive to water, we suggest you to consult our technical office.
- If the back of the tiles are very dusty, it is recommended to clean them by dipping them quickly in water.
- In adverse weather conditions (high temperatures, wind) the normal open time may be shorter. Therefore you must make

sure the adhesive has not formed a "skin" before laying the tile, which would compromise adhesion. If a "skin" has formed on the surface, simply refresh the adhesive by crossing again with the toothed trowel without wetting.

(See following)

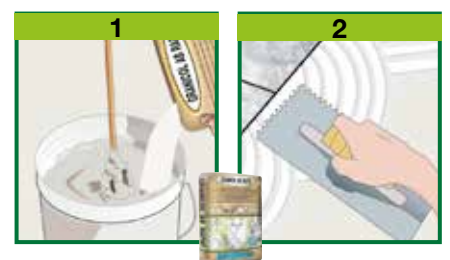

TECHNICAL CHARACTERISTICS

		GRANICOL AB RAPID	
		Standard	
		COMPONENT A	
		Powder	
		COMPONENT B	
		Latex	
Appearance		White	Grey
Colour			
Apparent density	EN 1015-6	1.30 ± 0.05 kg/L	1.01 ± 0.10 kg/L
Mix ratio		25	6
Shelf life in original packaging (dry stored)		12 months	
Mix characteristics and workability			
Density of mix		1.60 ± 0.05 kg/L	
Mix pH		12-14	
Pot life (*)		approx 1 hour	
Application temperature		+5°C ÷ +35°C	
Open time (*)		20 minutes	
Adjustability time (*)		30 minutes	
Waiting time - before foot traffic use (*)		6 hours	
Waiting time - before grouting (*)		6 hours	
Performance characteristics	Standard	Minimum requirement	Product performance
Class and type	EN 12004		C2FTES2
Transversal deformation class of adhesive	EN 12002	≥5.0 mm	5.1 mm - class S2
Adhesion strength	EN 1348 P8.2	≥1.00 N/mm ²	2.30 N/mm ²
Early tensile adhesion strength	EN 1348 P8.2	≥0.50 N/mm ²	0.60 N/mm ²
Adhesion strength - after immersion in water	EN 1348 P8.3	≥1.00 N/mm ²	1.80 N/mm ²
Adhesion strength - after heat	EN 1348 P8.4	≥1.00 N/mm ²	2.30 N/mm ²
Adhesion strength - after thaw-frost cycles	EN 1348 P8.5	≥1.00 N/mm ²	1.40 N/mm ²
Open time: adhesion strength - after 10'	EN 1346	≥0.50 N/mm ²	1.00 N/mm ²
Sliding	EN 1308	≤0,5 mm	0 mm
Thermal resistance - Operating temperature			-30°C ÷ +90°C
Fire reaction	EN 13501-1		E CWFT P4.4.3
Hazardous substances	EN 12004		in accordance to ZA.1 note

Test conditions: temperature 23±2°C, 50±5% R.H. and air velocity in test area <0.2 m/s. These data may change depending on specific site conditions: temperature, ventilation, moisture and substrate absorbency. (*) The times indicated will be longer or shorter as the temperature drops or rises.

(*) The times indicated will be longer or shorter as the temperature drops or rises.

Pursuant to European standard EN 12004:2007+A1:2012 - General principles for the use of products and systems.

(See previous)

- In high temperatures wetting the foundation helps to increase the open time.
- Never use with temperatures below +5°C and high than +35°C. Protect tiles from rain, frost and high temperature for 24 hours at least.
- In hot weather avoid laying the adhesive on large surface areas.
- Glue uniformly.
- Damp surfaces can slow the setting of the product.
- When overlaying, the surfaces must be washed well with water and caustic soda (9:1).
- Clean the tools with water and the covered surfaces with a damp cloth immediately after use.
- Do not expose the material to direct sunlight in hot weather.
- Store the original closed packaging in a dry place.

PACKAGING

GRANICOL AB RAPID

- 25-kg Sacks (component A)
- 6-kg Cans (component B)

• FOR ANY FURTHER INFORMATION OR ADVICE ON PARTICULAR APPLICATIONS, CONTACT OUR TECHNICAL OFFICE • IN ORDER TO CORRECTLY USE OUR PRODUCTS, REFER TO INDEX TECHNICAL SPECIFICATIONS •

 Construction Systems and Products Via G. Rossini, 22 - 37060 Castel D'Azzano (VR) - Italy - C.P.67 T. +39 045 8546201 - F. +39 045 518390	Internet: www.index-spa.com Informazioni Tecniche Commerciali tecom@indexspa.it Amministrazione e Segreteria index@indexspa.it Index Export Dept. index.export@indexspa.it		TOTAL QUALITY  UNI EN ISO 9001	Environmental Management Systems  UNI EN ISO 14001	 socio del GBC Italia	
			© INDEX			

the numerous possible uses and the possible interference of conditions or elements beyond our control, we assume no responsibility regarding the results which are obtained. The purchasers, of their own accord and under their own responsibility, must establish the suitability of the product for the envisaged use.

The figures shown are average indicative figures relevant to current production and may be changed or updated by INDEX at any time without previous warning. The advice and technical information provided, is what results from our best knowledge regarding the properties and the use of the product. Considering