









# INDEVER

BITUMINOUS SOLUTION CONTAINING BITUMEN AND QUICK-DRYING SOLVENTS

## INDEVER WET CONCRETE

BITUMINOUS SOLUTION CONTAINING BITUMEN AND QUICK-DRYING SOLVENTS, SUITABLE FOR APPLICATION ON SLIGHTLY DAMP SURFACES

CHARACTERISTICS		ENVIRONMENTAL	METHOD OF USE				PRECAUTIONS
							
SOLVENT BASED	ONE-COMPONENT		MIX MECHANICALLY	SPRAY APPLICATION	APPLY BY BRUSH	APPLY BY ROLLER	

### PROBLEM

#### BLOCK THE DUST ON THE CONCRETE SUPPORTS

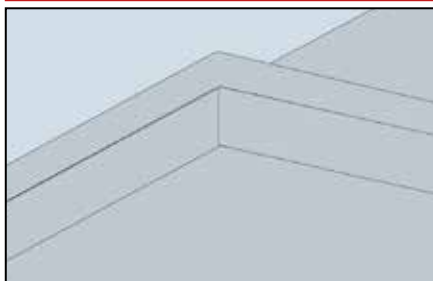

To block the effects of dust and minimise concrete porosity with a highly penetrating, quick-drying product which allows rapid waterproofing of the surface using polymer-bitumen membranes.

### SOLUTION

#### INDEVER

It is a bituminous primer made of a compound of solvents and oxidised bitumens. If applied as a thick waterproofing paint, when dry, INDEVER produces a film with a strong anchorage on every type of substrate without any degree of superficial stickiness. It also has excellent penetrating, adherence and consolidation properties when applied to dry concrete surfaces.

#### INDEVER WET CONCRETE

It is a bituminous primer made of a compound of oxidised bitumens, solvents and selected additives to improve anchorage, even on damp concrete surfaces (max 3%).

### APPLICATION FIELDS

#### INDEVER

It is suitable for saturating cement decks in addition to preparing an excellent anchorage for liquid bituminous waterproof coverings or prefabricated polymer-bitumen membranes.

**INDEVER** fixes superficial cement dust providing excellent adhesion for waterproofing layers which require a strong and permanent adhesion to the support. **INDEVER** is specifically used for applications on dry concrete viaducts and bridges before the application of polymer-bitumen membranes. **INDEVER** is used as a waterproofing paint on cement foundation walls, as a fixative and consolidating primer for surfaces in cement, timber and metal. Furthermore, **INDEVER** is used to protect and waterproof pipes and metal tanks or pipes both outdoors or underground.

#### INDEVER WET CONCRETE

It can be used for all of the same applications as INDEVER primer but also specifically on slightly damp surfaces.

### ADVANTAGES

- Rapid drying film.
- Excellent adhesion.
- Absence of stickiness
- High penetration.

### METHOD OF USE

#### • SURFACE PREPARATION

For the best results, the concrete surfaces to be treated should be as dry as possible when using **INDEVER** primer and slightly damp when using **INDEVER WET CONCRETE** primer. All surfaces must be perfectly clean and free from loose particles, oil, grease and dirt.

#### • APPLICATION

**INDEVER** and **INDEVER WET CONCRETE** are ready to use and does not need diluting; it can be applied by brush, broom or spray (1). The quantity of **INDEVER** primer to be used depends on the porosity of the surface and the type of finish required on the surface being treated. The polymer bitumen membranes are laid on the concrete surface, treated with primer (2), after leaving to dry for a time that ranges from a minimum of three hours (if perfectly exposed to the sun) to eight hours, in more critical conditions, to ensure total drying of the painted bi-

tumen film. A second coat can be possibly applied only after the first coat has dried perfectly.

#### • COVERAGE

The estimated yield on concrete surfaces is roughly 350-500 g/m<sup>2</sup>, while on metallic surfaces the yield is roughly 200-300 g/m<sup>2</sup>.

#### • PRECAUTIONS

- It's recommended to use water-based ECOVER instead of INDEVER on roofs of residential buildings.
- Do not use inside houses or in non-ventilated environments.
- Do not apply INDEVER and INDEVER WET CONCRETE on wet or very damp surfaces
- Do not mix INDEVER and INDEVER WET CONCRETE with cement or water.
- In the presence of sediment in the cans, we recommend mixing INDEVER and INDEVER WET CONCRETE well before use, until the

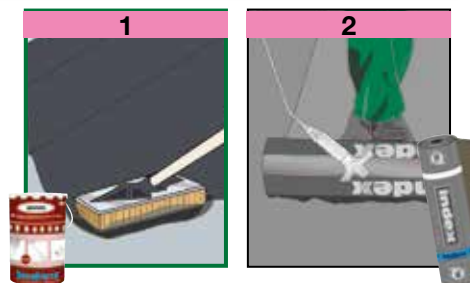

product is totally homogenised.

- Do not use INDEVER and INDEVER WET CONCRETE to waterproof tanks, cellars or drains subject to high water counterthrust or to water under pressure
- Do not use INDEVER and INDEVER WET CONCRETE to waterproof surfaces or containers in contact with liquids for human consumption

(See following)

## TECHNICAL CHARACTERISTICS

	Standard	INDEVER	INDEVER WET CONCRETE
Appearance		Liquid	Liquid
Colour		Black	Black
Density	<b>EN 2811-1</b>	0.94 ± 0.06 kg/L	0.97 ± 0.06 kg/L
Dry residue - at 130°C	<b>UNI EN ISO 3251</b>	40 ± 3%	50 ± 3%
DIN 4 cup viscosity	<b>UNI EN ISO 2431</b>	11 ÷ 17 seconds	17 ÷ 25 seconds
Flammability point - closed container	<b>ASTM D 3828-87</b>	> +23°C	> +23°C
Storage in original packaging in a dry place		24 months	24 months
<b>Mix characteristics and workability</b>			
Application temperature		+5°C ÷ +35°C	+5°C ÷ +35°C
Waiting time - for dust-free drying (*)		30÷60 minutes	30÷60 minutes
Waiting time - till tack-free drying (*)		100÷140 minutes	100÷140 minutes
Application		manual or spray application	manual or spray application

Test conditions: temperature 23±2°C, 50±5% R.H. and air velocity in test area <0.2 m/s. **These parameters may vary based on the specific conditions of the worksite: temperature, humidity, ventilation, porosity of the substrate.**

(\*) The times indicated will be longer or shorter as the temperature drops or rises.

(See previous)

- **sumption, drinking water or which may come into contact with solvents or mineral oils.**
- **After use clean tools using diesel or other common thinners (synthetic, white spirit or nitro thinner). It is recommended to immerse the tools in the thinner also during use, to prevent any product residue drying and making the tools unusable.**
- **Store in original packaging at temperatures above +5°C away from sources of heat and naked flames. Close the containers again after use.**

the numerous possible uses and the possible interference of conditions or elements beyond our control, we assume no responsibility regarding the results which are obtained. The purchasers, of their own accord and under their own responsibility, must establish the suitability of the product for the envisaged use.

The figures shown are average indicative figures relevant to current production and may be changed or updated by INDEX at any time without previous warning. The advice and technical information provided, is what results from our best knowledge regarding the properties and the use of the product. Considering

## PACKAGING

### INDEVER

- 200-litres drums.
- 20-litres pails.
- 10-litres pails.
- 5-litres cans.

### INDEVER WET CONCRETE

- 200-litres drums.
- 20-litres pails.

• FOR ANY FURTHER INFORMATION OR ADVICE ON PARTICULAR APPLICATIONS, CONTACT OUR TECHNICAL OFFICE • IN ORDER TO CORRECTLY USE OUR PRODUCTS, REFER TO INDEX TECHNICAL SPECIFICATIONS •

<p style="margin: 0;">Construction Systems and Products</p> <p style="margin: 0; font-size: 0.8em;">Via G. Rossini, 22 - 37060 Castel D'Azzano (VR) - Italy - C.P.67 T. +39 045 8546201 - F. +39 045 518390</p>	<p style="font-size: 0.8em;">Internet: <a href="http://www.index-spa.com">www.index-spa.com</a>                  Informazioni Tecniche Commerciali  <a href="mailto:tecom@indexspa.it">tecom@indexspa.it</a>                  Amministrazione e Segreteria  <a href="mailto:index@indexspa.it">index@indexspa.it</a>                  Index Export Dept.  <a href="mailto:index.export@indexspa.it">index.export@indexspa.it</a></p>		<div style="border: 1px solid black; padding: 2px; font-size: 0.7em; text-align: center;">                 TOTAL QUALITY  <b>index</b>                    UNI EN ISO  <b>9001</b> </div>	<div style="border: 1px solid black; padding: 2px; font-size: 0.7em; text-align: center;">                 Environmental                  Management Systems  <b>index</b>                    UNI EN ISO  <b>14001</b> </div>	<p style="font-size: 0.7em;">index "GBC Italia" Associated</p>	
---	--	--	--	---	--	--