









PREFIX FIBERPROOF

SOLVENT-BASED PENETRATING AND CONSOLIDATING PRIMER FOR RENDERING DETERIORATED AND BRITTLE ASBESTOS CEMENT SHEETS HARMLESS THROUGH ENCAPSULATION. TO BE APPLIED BEFORE THE COLOURED WATER-BASED WATERPROOF COATING OF ELASTOLIQUID PUR

CHARACTERISTICS		ENVIRONMENTAL	METHOD OF USE				PRECAUTIONS
							
SOLVENT BASED	ONE-COMPONENT		MIX MECHANICALLY	SPRAY APPLICATION	APPLY BY BRUSH	APPLY BY ROLLER	

PROBLEM

CONSOLIDATING THE SURFACES OF ASBESTOS CEMENT SHEETS FOR ENCAPSULATION



That of rendering asbestos cement roof sheeting harmless is becoming an increasingly important matter, with regard to safeguarding the environment, in view of the hazards caused by the continuous dispersion of the asbestos fibres in the air. One of the reclamation methods approved by the Ministerial Decree dated 6th September 1994, Law no. 257/92, is that of encapsulating the sheets. To bring the emission levels of asbestos fibres on the roof down to legal limits, the brittle surface has to be encapsulated by applying suitable penetrating and covering products, even without having to clean, in some cases, the soiled surface using high-pressure water cleaners, in compliance with applicable laws.

SOLUTION

PREFIX is a fixing penetrating primer containing synthetic resins dissolved in a solvent.

FIBERPROOF is a consolidating penetrating primer containing synthetic resins dissolved in a solvent.

The important characteristics of these products is their capacity to penetrate deeply into the dirty, loose surface of the asbestos sheet or slab providing a highly adhesive surface and a good base for the following treatment with water-based ELASTOLIQUID PUR which contains acrylic elastomers and is applied in two different coloured coats.

The painted films are different in colour to be able to distinguish the zones that have been treated with it, according to the provisions of current standards. Once dry, the films are tough and non-degradable; they also offer excellent resistance against weathering and ultra violet rays.

APPLICATION FIELDS

Penetrating primers recommended for rendering asbestos cement sheets harmless prior to encapsulation with coloured coating products.

ADVANTAGES

- Good adhesion and penetration on asbestos cement sheets with flaking surfaces.
- Excellent consolidating properties against surface dirt.
- Perfect adhesion of the water-coloured, acrylic-elastomer, encapsulating coating film of ELASTOLIQUID PUR on FIBERPROOF primer.
- Insensitivity to water.

METHOD OF USE

RENDERING TYPE "A" ASBESTOS-CEMENT SHEETS HARMLESS THROUGH ENCAPSULATION

Types of intervention in accordance with UNI10686 dated March 1998 "Appendix 2" approved by the Decree dated 20th August 1999, relevant to the extension of law no. 257 dated 27th March 1992.

A1 • Encapsulating treatment on the upper face (extrados) of clean asbestos cement sheets (type A: visible from the outside) with an average thickness of 300 µm.

1. Application of the first fixative penetrating coat of blue solvent-based **PREFIX** with a yield of roughly 250 g/m² (2).

2. Application of two coats of the water-based waterproof coating ELASTOLIQUID PUR in two different and contrasting colours with a yield of approximately 450 g/m² per coat (4).

A2 • Encapsulating treatment on the upper face (extrados) of slightly soiled asbestos cement sheets (type A: visible from the out-

side) with average thickness of 300 µm.

These surfaces may be problematic to prepare. In fact, on one hand, common application practice requires all the soiled part to be removed, but in some cases on the other, after an attentive assessment on a case-to-case basis, the sheets can be encapsulated directly. It is however crucial to remove any moss that has grown on the surface using mechanical tools with vacuum pumps and suitable filters, in

(See following)

CERTIFICATE OF CONFORMITY



Certificate of conformity "Istituto Giordano"

Technical and scientific suitability for rendering items in "A" type asbestos cement, harmless in the cycle with ELASTOLIQUID PUR.

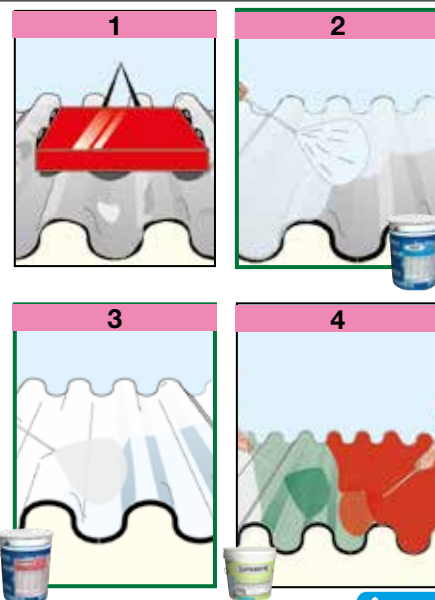

TECHNICAL CHARACTERISTICS

	Standard	PREFIX	FIBERPROOF
Appearance		Liquid	Liquid
Colour		Light blue	White
Density	EN 2811-1	0.90 ± 0.05 kg/L	0.95 ± 0.05 kg/L
DIN 4 cup viscosity	UNI EN ISO 23431	20 ± 5 seconds	20 ± 5 seconds
Dry residue - at 130°C		25 ± 2%	35 ± 2%
Flammability point - closed container	ASTM D-3828-8F	>+23°C	>+23°C
Storage in original packaging in a dry place		12 months	12 months
Workability characteristics			
Application thickness		0.3 mm	0.3 mm
Waiting time - for dust-free drying (*)		30 minutes	40 minutes
Waiting time - till tack-free drying (*)		60 minutes	60 minutes
Waiting time - for total dry (*)		1 ÷ 2 hours	1 ÷ 2 hours
Application temperature		+5°C to +35°C	+5°C to +35°C
Application		manual or spray	manual or spray

Test conditions: temperature 23±2°C, 50±5% R.H. and air velocity in test area <0.2 m/s. These parameters may vary based on the specific conditions of the worksite: temperature, humidity, ventilation, porosity of the substrate.

(*) The times indicated will be longer or shorter as the temperature drops or rises.

(See previous)

accordance with law (1).

1. Application of the first fixative penetrating and consolidating coat of blue solvent-based **PREFIX** with a yield of roughly 200 g/m² (2).
2. Application of a coat of penetrating and consolidating white solvent-based **FIBREPROOF** with a yield of roughly 250 g/m² per coat (3).
3. Application of two coats of the water-based waterproof coating **ELASTOLIQID PUR** in two different and contrasting colours with a yield of approximately 450 g/m² per coat (4).

• COVERAGE

The yield of **PREFIX** and **FIBERPROOF** is approximately 200-250 g/m² per coat.

• PRECAUTIONS

- Keep the containers sealed before use.
- Apply at temperatures between +5°C and +35°C. Extreme conditions of heat and cold must be avoided during application. Do not apply if the temperature is likely to drop below +5°C while the paint film is drying.
- Do not mix with cement or water.
- Apply by spraying each coat in the opposite direction to the previous one, so as to ensure total surface coverage.
- Apply the second coat of **FIBERPROOF** only when the first coat of **PREFIX** is perfectly dry.

- Do not use the product for surfaces or containers in contact with liquids for human consumption, drinking water or which may come into contact with solvents or mineral oils.
- Clean equipment with white spirit or synthetic thinners.
- Store **PREFIX** and **FIBERPROOF** in their original packaging, away from heat sources and naked flame, as it is a flammable product.

The numerous possible uses and the possible interference of conditions or elements beyond our control, we assume no responsibility regarding the results which are obtained. The purchasers, of their own accord and under their own responsibility, must establish the suitability of the product for the envisaged use.

The figures shown are average indicative figures relevant to current production and may be changed or updated by INDEX at any time without previous warning. The advice and technical information provided, is what results from our best knowledge regarding the properties and the use of the product. Considering

PACKAGING

PREFIX

20-litres Pail

FIBERPROOF

20-litres Pail

• FOR ANY FURTHER INFORMATION OR ADVICE ON PARTICULAR APPLICATIONS, CONTACT OUR TECHNICAL OFFICE • IN ORDER TO CORRECTLY USE OUR PRODUCTS, REFER TO INDEX TECHNICAL SPECIFICATIONS •

 <p>Construction Systems and Products</p> <p>Via G. Rossini, 22 - 37060 Castel D'Azzano (VR) - Italy - C.P.67 T. +39 045 8546201 - F +39 045 518390</p>	<p>Internet: www.index-spa.com Informazioni Tecniche Commerciali tecom@indexspa.it Amministrazione e Segreteria index@indexspa.it Index Export Dept. index.export@indexspa.it</p>		<p>TOTAL QUALITY Index</p>  <p>UNI EN ISO 9001</p>	<p>Environmental Management Systems index</p>  <p>UNI EN ISO 14001</p>	 <p>socio del GBC Italia</p>	
--	--	---	---	--	---	---