

FUGOGLASS

GROUTING MORTAR FOR GLASS BRICKS,
WITH IMPROVED ADHESION FOR INTERIOR AND EXTERIOR USE



GRANTS *LEED* CREDITS

CHARACTERISTICS	ENVIRONMENTAL	METHOD OF USE		PRECAUTIONS
	ECO GREEN	RECYCLABLE	MIX MECHANICALLY	APPLY BY TROWEL
				STORAGE: IN A DRY PLACE

PROBLEM

LAY AND GROUT GLASS BRICK COMPOSITION WITH ONE PRODUCT ONLY



SOLUTION

FUGOGLASS is a special, premixed, white, powder mortar made of highly resistant cement, selected quartz aggregates, additives and powder resins that improve workability and adhesion.



APPLICATION FIELDS

FUGOGLASS can be used for laying all types of glass tiles and for grouting. It can also be used for filling big holes and which high resistance and adhesion are required.

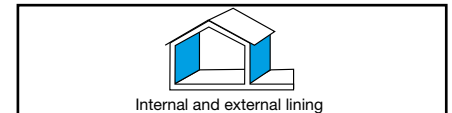

Internal and external lining

ADVANTAGES

- Fast laying.
- High adhesion.
- Easy to clean.

METHOD OF USE

• SURFACE PREPARATION

The surfaces where the tiles will be laid must be clean and free of traces of dust, oils, greases and paints etc.

• MIX PREPARATION

FUGOGLASS is prepared by mixing the product with right quantity clean water (see table). Pour the powder product into the water and mix with a drill on low speed until a uniform paste is obtained with no lumps (1).



• APPLICATION

FUGOGLASS should be applied using a spatula or trowel spreading the product uniformly over the entire surface where the tiles will be laid (2). Lightly press the glass tiles (3) so that the excess product is squeezed out and can then be removed (4).

The subsequent finishing should be done with a damp sponge (5).

• COVERAGE

10-12 kg/m² f glass tiles.

• PRECAUTIONS

- The pot life may be greatly reduced in unfavourable climatic conditions (high temperatures, wind, etc.).
- Don't use **FUGOGLASS** at temperatures below + 5°C and protect the tiles

from frost and high temperatures after laying.

- Clean tools with water and the tiled surfaces with a damp cloth immediately after laying.
- Store in a dry place.

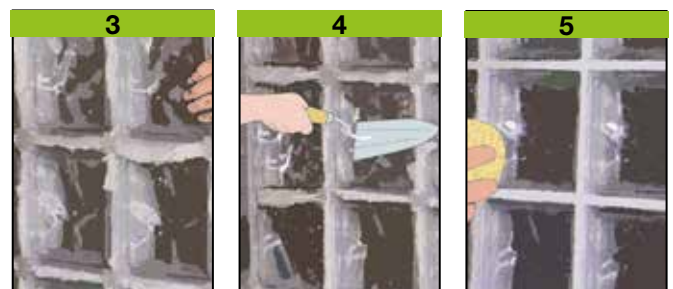

TECHNICAL CHARACTERISTICS

		FUGOGLASS
	Standard	
Appearance		Powder
Colour		White
Apparent density	EN 1015-6	1.35 ± 0.10 kg/L
Water mix ratio		21%
Shelf life in original packaging (dry stored)		12 months
Mix characteristics and workability		
Density of mix		1.80 ± 0.10 kg/L
Application temperature		+5°C ÷ +35°C
Pot life (*)		90 minutes
Waiting time - before foot traffic use (initial hardening) (*)		24 hours
Waiting time - final hardening (*)		14 days
Performance characteristics		Product performance
Class and type	Standard	
Class and type	EN 13888	CG1
Compression strength - after 28 days	EN 12808-3	≥15 N/mm ²
Compression strength - after thaw-frost cycles	EN 12808-3	≥15 N/mm ²
Bending strength - after 28 days	EN 12808-3	≥2.5 N/mm ²
Bending strength - after thaw-frost cycles	EN 12808-3	≥2.5 N/mm ²
Resistance to abrasion	EN 12808-2	≤2 000 mm ³
Linear shrinkage	EN 12808-4	≤3 mm/m
Reduced water absorption - after 30 minutes	EN 12808-5	≤5 g
Reduced water absorption - after 240 minutes	EN 12808-5	≤10 g
Thermal resistance - Operating temperature		-30°C ÷ +90°C

Test conditions: temperature 23±2°C, 50±5% U.R. and speed in the air in the testing area <0,2 m/s. **These data may change depending on specific site conditions: temperature, ventilation, moisture and substrate absorbency.**

(*) The times indicated will be longer or shorter as the temperature drops or rises.

According to the european norm **EN 13888** - General principles for the use of products and systems.

the numerous possible uses and the possible interference of conditions or elements beyond our control, we assume no responsibility regarding the results which are obtained. The purchasers, of their own accord and under their own responsibility, must establish the suitability of the product for the envisaged use.

The figures shown are average indicative figures relevant to current production and may be changed or updated by INDEX at any time without previous warning. The advice and technical information provided, is what results from our best knowledge regarding the properties and the use of the product. Considering

PACKAGING

15-kg-Sack

• FOR ANY FURTHER INFORMATION OR ADVICE ON PARTICULAR APPLICATIONS, CONTACT OUR TECHNICAL OFFICE • IN ORDER TO CORRECTLY USE OUR PRODUCTS, REFER TO INDEX TECHNICAL SPECIFICATIONS •

 Construction Systems and Products Via G. Rossini, 22 - 37060 Castel D'Azzano (VR) - Italy - C.P.67 T. +39 045 8546201 - F. +39 045 518390	Internet: www.index-spa.com Informazioni Tecniche Commerciali tecom@indexspa.it Amministrazione e Segreteria index@indexspa.it Index Export Dept. index.export@indexspa.it		 UNI EN ISO 9001	 UNI EN ISO 14001		
---	---	---	---	---	---	---