

EPOXYBETON ABC

IMPERMEABLE EPOXY CEMENT TRICOMPONENT LEVELLING MORTAR
WITH A LOW ELASTIC MODULE

CHARACTERISTICS			ENVIRONMENTAL	METHOD OF USE		PRECAUTIONS
THREE-COMPONENT	WATER BASED	WATERPROOF		MIX MECHANICALLY	APPLY BY ROLLER	STORAGE: KEEP AWAY FROM FROST

PROBLEM

PROTECTING THE SURFACES OF EXPOSED DECKS

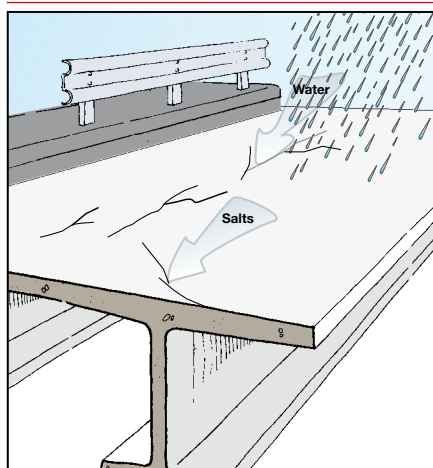

SOLUTION

EPOXYBETON ABC is an impermeable pre-mixed mortar with high mechanical and chemical resistance and a low elastic module.

EPOXYBETON ABC consists of 2 liquid components and a powder component: Component "A" is a mixture of special epoxy resins, component "B" consists of a mixture of special hardeners, component "C" is a cement, quartz sand based premix in selected curve with additives that enhance workability and performance.

This special system provides a very workable liquid mortar with innovative features compared to the old systems: high chemical, mechanical, impact and abrasion resistance combined with a low elastic module and easy workability.



APPLICATION FIELDS

EPOXYBETON ABC may be used as an impermeable levelling agent on concrete, mortar to repair industrial concrete paving, protective treatment for the exposed surfaces of bridge slabs for protection against aggressive chemicals, vapour barrier and to execute subsequent waterproofing treatments on decks, balconies, terraces, underground spaces etc., also when subject to water counter thrust and chemical attacks (salt, chloride, sulphates, etc.). It is also ideal in aggressive environments such as the marine environment.

ADVANTAGES

- High adhesion.
- High impermeability.
- High chemical and mechanical resistance.
- Low elastic module.

METHOD OF USE

• SURFACE PREPARATION

Existing concrete or concrete mortar surfaces must be carefully cleaned of oils, grease, dust and suitably treated prior to the application with BASE PRIMER AB water epoxy primer (1).

• MIX PREPARATION

Mix component A with component B and 2 litres of water (2). Mix with a drill at low speed for the time necessary to form a fluid paste avoiding any air bubbles.

Add component C (powder) and mix until a creamy lump-free mix is obtained (3).

Depending on the type of use, dilute with water by mixing until a fluid mortar is obtained (max 2 litres of clean water).

• APPLICATION

Pour the levelling mortar on the clean sup-

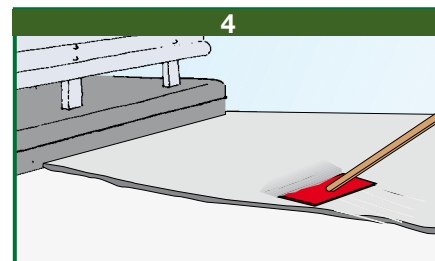
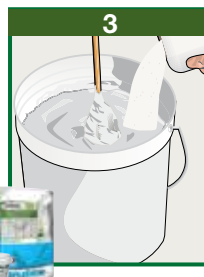
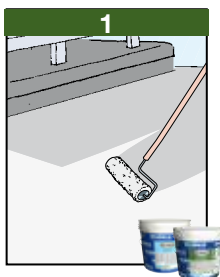

port and spread it with a suitable spatula or rake, taking it to the maximum thickness of 5 mm in a single coat (4).

Thicknesses varying from 1 mm to 10 mm, in several coats, can be obtained. To improve the performance in case of high thicknesses, we advise interposing a reinforcement fibre-glass mesh type RETINVETRO PER RASANTI (light 4 x 5 mm).

• COVERAGE

About 1.6 kg/m²×mm.

• PRECAUTIONS

- The use time of the mix is about 30 minutes at a temperature of 20°C.
- Do not add water while setting.
- Immediately clean tools after use with water or alcohol.
- Do not use in temperatures lower than +5°C.
- Protect the applied mix from frost and high temperatures.

TECHNICAL CHARACTERISTICS

	Standard	EPOXYBETON ABC		
		COMPONENT A	COMPONENT B	COMPONENT C
Appearance		Creamy fluid	Creamy fluid	Powder
Mix ratio		4	4	24
Density	EN 2811-1	1.14 ± 0.10 kg/L	1.00 ± 0.10 kg/L	1.35 ± 0.05 kg/L
Colour		Grey		
Storage in original packaging in a dry place, away from frost		12 months		
Mix properties and workability				
Density of mix		1.60 ± 0.05 kg/L		
Wait time - till tack-free drying (*)		24 hours		
Wait time - for complete hardening (*)		7 days		
Minimum application thickness		1 mm		
Maximum application thickness		10 mm - in more coats		
Application temperature		+10°C ÷ +35°C		
Application		Manual		
Performance characteristics	Standard	Product performance		
Class and type	EN 1504-3	R3 - CC		
Compression strength - after 28 days	EN 12190	≥35 MPa		
Bending strength - after 28 days	EN 196-1	≥8 MPa		
Chloride ion content	EN 1015-17	Absent		
Bond strength	EN 1542	≥2.0 MPa		
Thermal compatibility frost-thaw cycles - Part 1	EN 13687-1	≥1.5 MPa		
Capillarity water absorption	EN 13057	w ≤ 0.5 kg/m²·h ^{0.5} - W1		
Durability - Resistance to carbonation	EN 13295	Test passed		
Elastic compression modulus		12 GPa		
Thermal resistance - Operating temperature		-30°C ÷ +90°C		
Fire reaction	EN 13501-1	A1		
Hazardous substances	EN 1504-3	in accordance to ZA.1 note		

Test conditions: temperature 23±2°C, R.H. 50±5% and air speed in test area <0.2 m/s. The data shown may vary depending on the specific work site conditions: temperature, humidity, ventilation, absorbency of the base coat.

(*) The times indicated will be longer or shorter as the temperature drops or rises.

Compliant with the general principles defined in EN 1504-9 - Principles for evaluating the use of products and systems.

The numerous possible uses and the possible interference of conditions or elements beyond our control, we assume no responsibility regarding the results which are obtained. The purchasers, of their own accord and under their own responsibility, must establish the suitability of the product for the envisaged use.

The figures shown are average indicative figures relevant to current production and may be changed or updated by INDEX at any time without previous warning. The advice and technical information provided, is what results from our best knowledge regarding the properties and the use of the product. Considering

PACKAGING

EPOXYBETON ABC

- Component A: 4-kg-bucket
- Component B: 4-kg-bucket
- Component C: 25-kg-bucket

• FOR ANY FURTHER INFORMATION OR ADVICE ON PARTICULAR APPLICATIONS, CONTACT OUR TECHNICAL OFFICE • IN ORDER TO CORRECTLY USE OUR PRODUCTS, REFER TO INDEX TECHNICAL SPECIFICATIONS •

 <p>Construction Systems and Products</p> <p>Via G. Rossini, 22 - 37060 Castel D'Azzano (VR) - Italy - C.P.67 Tel. (+39)045.8546201 - Fax (+39)045.518390</p>	<p>Internet: www.index-spa.com Informazioni Tecniche Commerciali tecom@indexspa.it Amministrazione e Segreteria index@indexspa.it Index Export Dept. index.export@indexspa.it</p>		 <p>UNI EN ISO 9001</p>	 <p>UNI EN ISO 14001</p>	 <p>socio del GBC Italia</p>	
--	--	---	---	---	---	--