



# BLOCKYBOND

ADHESIVE AND SMOOTHING MORTAR FOR CELLULAR CEMENT BLOCKS

GRANTS *LEED* CREDITS

CHARACTERISTICS	ENVIRONMENTAL	METHOD OF USE			PRECAUTIONS	
ALLOWS TO BREATHE	ECO GREEN	RECYCLABLE	MIX MECHANICALLY	APPLY BY TOOTHED SPATULA	APPLY BY TROWEL	STORAGE: IN A DRY PLACE

## PROBLEM

**BOND AND SMOOTH LIGHTWEIGHT CEMENT BLOCKS USING A SINGLE PRODUCT**



## SOLUTION

**BLOCKYBOND** is a pre-mixed adhesive mortar in powder form consisting of cement, selected sand, synthetic fibres and special additives guaranteeing excellent workability and adhesion.



## APPLICATION FIELDS

**BLOCKYBOND** is used indoors and outdoors for completing lightweight walls made of cellular cement blocks and thermal bricks. Moreover, it can be used for smoothing indoor and outdoor walls.

## ADVANTAGES

- Easy to use.
- Dual-purpose: adhesive and smoothing mortar.

## METHOD OF USE

### • SURFACE PREPARATION

The masonry elements must be solid, flat and free of flaking parts, dust, oil, grease and dirt in general.

Gypsum surfaces must be solid, dry and treated with Isolfix G prior to applying **BLOCKYBOND**.

### • PREPARING THE MIX

**BLOCKYBOND** must be mixed with 24% clean water (6 litres for one 25 kg bag) using a low-speed mechanical stirrer (1).

Mix the product until obtaining a uniform lump-free mix, while constantly adding powder to the water.

### • APPLICATION

Apply the mix uniformly using the notched trowel or brick trowel (2). If necessary, wet the highly absorbent blocks if used in hot weather. The blocks laid with **BLOCKYBOND** must not be washed or exposed to rain, vertical loads and lateral thrusts for at least 24 hours.

**BLOCKYBOND** can also be used for smoothing surfaces when applied with a stainless steel trowel (3).

### • COVERAGE

Around 4–6 kg/m<sup>2</sup> of surface to be bonded. As a smoothing mortar: 1.4 kg/m<sup>2</sup> xmm.

### • PRECAUTIONS

- Do not add on too many blocks before the underlying adhesive product has hardened.
- In case of hot temperatures, wet the underlying surface to help prolong the open time.
- In unfavourable weather conditions (high temperatures, wind), the open time – normally around 20–25 minutes – may be significantly shorter. It is therefore necessary to check that the adhesive mortar has not formed a 'skin' before laying. Should a 'skin' form, simply apply a fresh layer without wetting the surface.

- Do not use **BLOCKYBOND** with temperatures below +5 °C and protect the surface after laying against frost and high temperatures.
- Clean tools with water and the coated surfaces with a damp cloth.
- Store in a dry place.

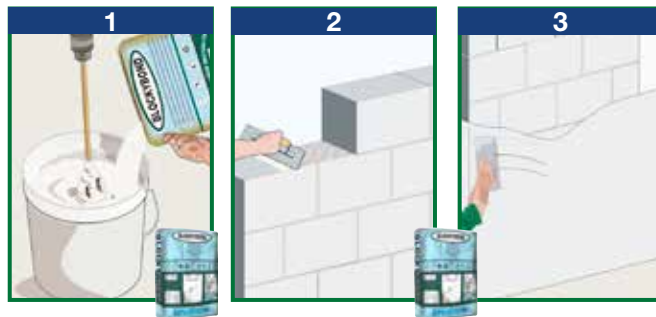

## TECHNICAL CHARACTERISTICS

	Standard	<b>BLOCKYBOND</b>
Appearance		Powder
Colour		White - Grey
Particle size		0÷4 mm
Apparent density	<b>EN 1015-6</b>	1.40 ± 0.10 kg/L
Mixing water		24% ± 1%
Storage in original packaging in a dry place		12 months
<b>Mix properties and workability</b>		
Density of the mix		1.65 ± 0.10 kg/L
Application temperature		+5°C ÷ +35°C
Minimum application thickness		1.0 mm
Maximum application thickness per layer		15.0 mm
Application		Manual
<b>Performance characteristics</b>	<b>Standard</b>	<b>Product performance</b>
<b>Class and type</b>	<b>EN 998-2</b>	<b>M10</b>
<b>Resistance to compression - after 28 days</b>	<b>EN 1015-11</b>	11.0 N/mm <sup>2</sup> - CS IV
Resistance to bending - after 28 days	<b>EN 1015-11</b>	4.4 N/mm <sup>2</sup>
<b>Adhesion</b>	<b>EN 1015-12</b>	≥0.5 N/mm <sup>2</sup> - FP: B
<b>Water absorption through capillarity</b>	<b>EN 1015-18</b>	w ≤ 0.4 kg/m <sup>2</sup> ·h <sup>0.5</sup> - W1
<b>Water vapour permeability coefficient</b>	<b>EN 1015-19</b>	μ = 15÷20
<b>Thermal conductivity</b> λ <sub>-10,dry</sub>	<b>EN 1745 A.12</b>	0.76 W/mK
<b>Durability</b>	<b>EN 998-2</b>	5.4.7 compliant
<b>Chloride ion content</b>	<b>EN 1015-17</b>	Absent
<b>Initial shear resistance</b>	<b>EN 998-2 App.C</b>	≥0.15 N/mm <sup>2</sup>
Compressive elastic modulus		2 550 N/mm <sup>2</sup>
Thermal resistance - Working temperature		-30°C ÷ +90°C
<b>Reaction to fire</b>	<b>EN 13501-1</b>	A1
<b>Hazardous substances</b>	<b>EN 998-2</b>	According to note in ZA.1

Test conditions: temperature 23±2°C, R.H. 50±5% and air speed in the test area <0.2 m/s. **These figures may vary depending on the specific conditions of the worksite: temperature, humidity, ventilation, absorbency of the base coat.**

(\*) The stated times may be longer or shorter as the temperature decreases or increases.

Compliant with the general principles defined in **EN 998-1** - Principles for evaluation of the use of products and systems.

The numerous possible uses and the possible interference of conditions or elements beyond our control, we assume no responsibility regarding the results which are obtained. The purchasers, of their own accord and under their own responsibility, must establish the suitability of the product for the envisaged use.

The figures shown are average indicative figures relevant to current production and may be changed or updated by INDEX at any time without previous warning. The advice and technical information provided, is what results from our best knowledge regarding the properties and the use of the product. Considering

## PACKAGING

**BLOCKYBOND**  
25-kg Sack

• FOR ANY FURTHER INFORMATION OR ADVICE ON PARTICULAR APPLICATIONS, CONTACT OUR TECHNICAL OFFICE • IN ORDER TO CORRECTLY USE OUR PRODUCTS, REFER TO INDEX TECHNICAL SPECIFICATIONS •

 <p><b>index</b> Construction Systems and Products</p> <p>Via G. Rossini, 22 - 37060 Castel D'Azzano (VR) - Italy - C.P.67 T. +39 045 8546201 - F. +39 045 518390</p>	<p>Internet: <a href="http://www.index-spa.com">www.index-spa.com</a> Informazioni Tecniche Commerciali <a href="mailto:tecom@indexspa.it">tecom@indexspa.it</a> Amministrazione e Segreteria <a href="mailto:index@indexspa.it">index@indexspa.it</a> Index Export Dept. <a href="mailto:index.export@indexspa.it">index.export@indexspa.it</a></p>		 <p>TOTAL QUALITY <b>index</b> UNI EN ISO <b>9001</b></p>	 <p>Environmental Management Systems <b>index</b> UNI EN ISO <b>14001</b></p>	 <p><b>index</b> socio del GBC Italia</p>	
--	--	---	---	--	--	---